

2020 Late-Spring Curlyleaf Pondweed Delineation

Lake Martha (# 86-0009)

Wright County, MN

Surveyed June 3, 2020



Survey, Analysis, and Reporting by:

James A. Johnson – *Aquatic Ecologist, Freshwater Scientific Services, LLC*



Certified Lake Manager
www.NALMS.org

Purpose of Survey

This late-spring survey was designed to assess the distribution and density of curlyleaf pondweed (CLP) throughout Lake Martha (#86-0009). This information will help to guide any CLP management plans in the coming years, and is required as a part of the DNR permitting process.

Survey Method

CLP Delineation Survey

Freshwater Scientific Services surveyed the vegetated portion of Lake Martha on June 3, 2020. During this survey, we navigated a meandering path over the search area while using a combination of surface observations, rake tosses, and sonar readings, to locate and delineate areas of CLP growth. Sonar and visual assessments were conducted continuously, with subsequent rake tosses to assess CLP abundance at locations where plants were not identifiable from the surface. When we encountered CLP plants, we marked the location, recorded the water depth, and rated the density of the growth using visual and rake density scores as described in the table below.

Score	Visual	Rake
1	Light / Solitary plants	1-2 stems
2	Moderate / Scattered dense patches	3 to 9 stems
3	Dense / Uniform dense growth	10+ stems

For rake samples, we dragged a sampling rake over approximately 10 square feet of lake bottom and recorded the CLP density based upon the number of plants (stem count) retrieved on the rake. The recorded water depths and density scores were linked to the appropriate GPS locations and then mapped using desktop GIS software.

Lake Martha (#86-0009) 2020 Curlyleaf Pondweed Delineation

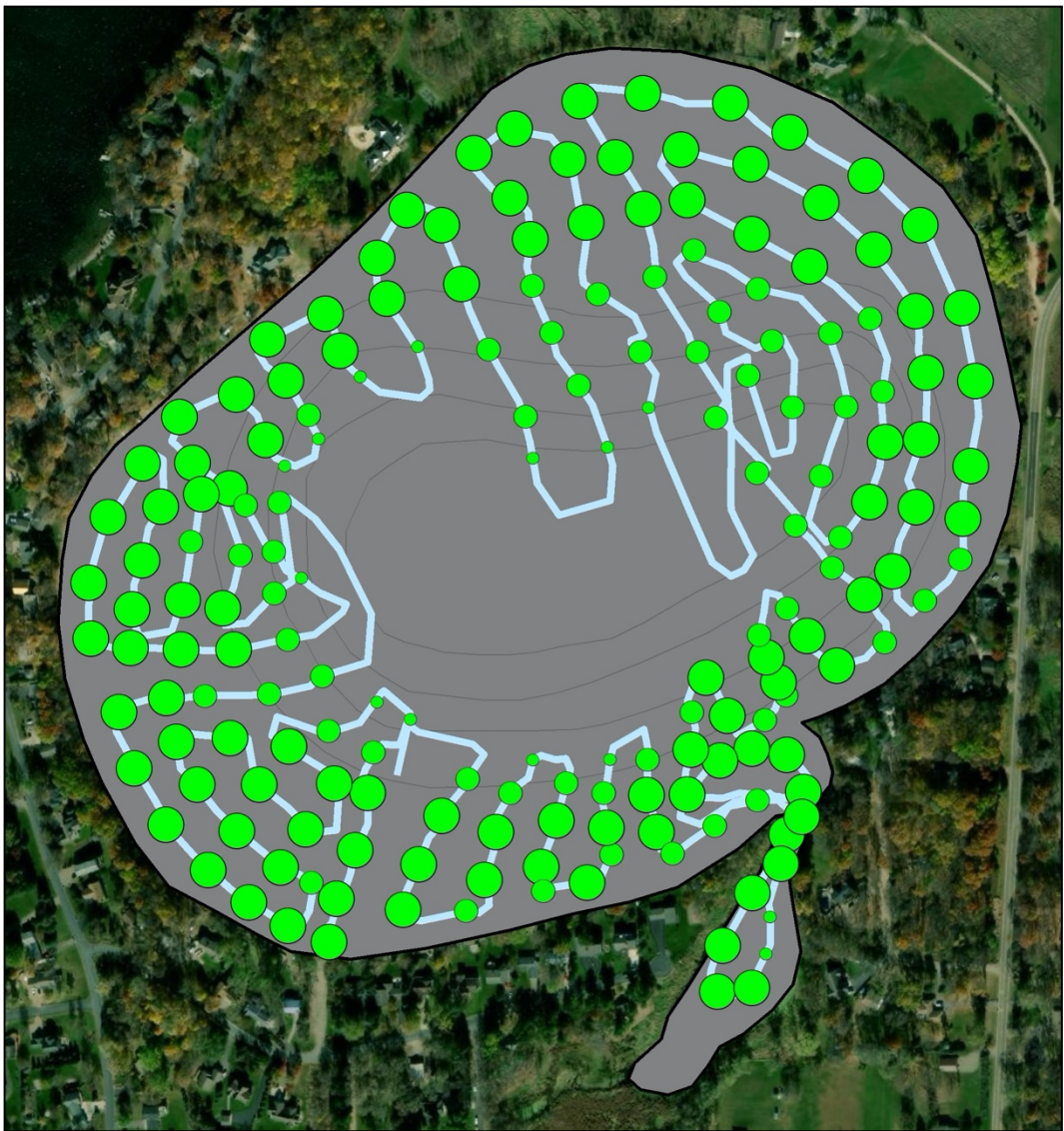

— Surveyed Path

CLP Density

- 1
- 2
- 3

Surveyed: June 3, 2020
Methods: Visual, Rake, Sonar
Surveyor: JA Johnson



Map produced for the
Lake Martha Improvement Association by:



15771 Creekside Lane
Osseo, MN 55369
fixmylake.com
(651) 336-8696

Online Resources & Contacts

Minnesota Administrative Rules for Aquatic Plant Management

<https://www.revisor.mn.gov/rules/?id=6280>

Minnesota DNR – Aquatic Plant Management Regulations & Permit Application Forms

<http://www.dnr.state.mn.us/apm/index.html>

Christine Jurek

Invasive Species Specialist

Minnesota DNR

christine.jurek@state.mn.us

(320) 223-7847

Wendy Crowell

AIS Management Coordinator

Minnesota DNR

wendy.crowell@state.mn.us

(651) 259-5085